

Product: SKID STEER LOADER

Model: 236B3 SKID STEER LOADER A9H

Configuration: 236B3 Skid Steer Loader A9H00001-UP (MACHINE) POWERED BY C3.4 IND Engine

Disassembly and Assembly

259B3 Compact Track Loader, 247B3 and 257B3 Multi Terrain Loaders and 216B3, 226B3, 236B3, 242B3 and 252B3 Skid Steer Loaders Power Train

Media Number -UENR0251-07

Publication Date -01/07/2018

Date Updated -11/07/2018

i02358306

Piston Pump (Hydrostatic) - Disassemble

SMCS - 5070-015-H7

Disassembly Procedure

Table 1

Required Tools			
Tool	Part Number	Part Description	Qty
A	9U-7289	Ruler	1
B	1P-1861	Retaining Ring Pliers	1
C	138-7576	Link Brackets	2
D	8T-4956	Bolts (M12 - 1.75 - 35 MM)	2
E	8T-4223	Hard Washers (13.5 - 25.5 - 3 MM THK)	2
F	1P-0510	Driver Gp	1
G	1P-1854	Retaining Ring Pliers	1
H	1U-7600	Slide Hammer Puller Gp	1
J	1P-1860	Retaining Ring Pliers	1
K	8H-0663	Bearing Puller Gp	1

Start By:

- a. Remove the piston pump. Refer to Disassembly and Assembly, "Piston Pump - Remove".

Note: The following procedure is intended for cleaning purposes only.



Illustration 1

g00903455

1. Remove the fittings and connectors (1).
2. Remove speed sensing valve (2).

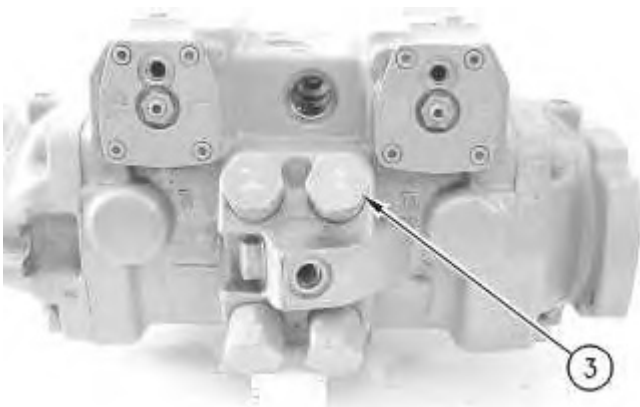

Illustration 2

g00903457

 **WARNING**

Personal injury can result from being struck by parts propelled by a released spring force.

Make sure to wear all necessary protective equipment.

Follow the recommended procedure and use all recommended tooling to release the spring force.

3. Remove cover (3) and the spring for the crossover relief valve.



Illustration 3

g00903461

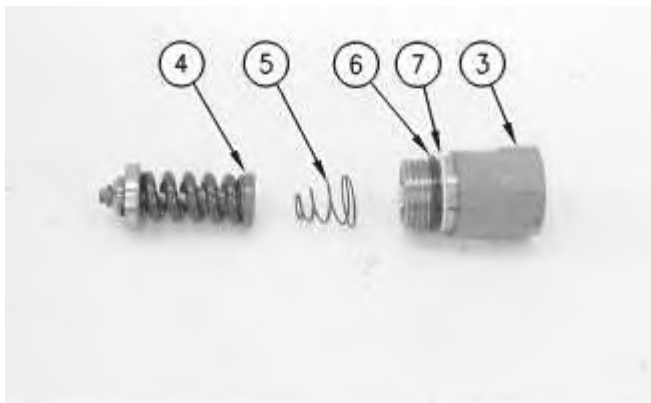

Illustration 4

g00903467

4. Remove seat (4).
5. Note the orientation of spring (5).
6. Remove O-ring seal (6) from cover (3).
7. Remove back up ring (7) from cover (3).
8. Repeat Step 3 through Step 7 for the other covers.

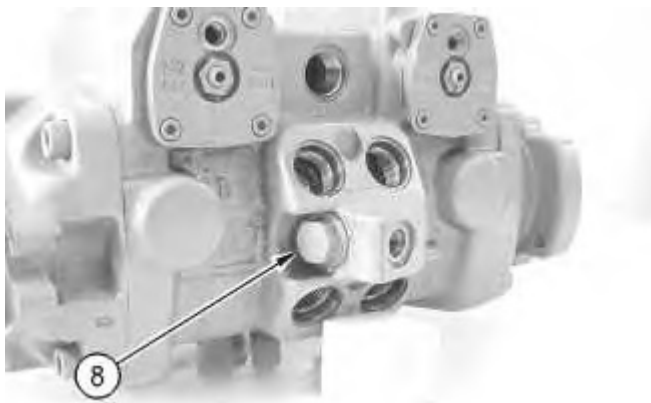

Illustration 5

g00903500

WARNING

Personal injury can result from being struck by parts propelled by a released spring force.

Make sure to wear all necessary protective equipment.

Follow the recommended procedure and use all recommended tooling to release the spring force.

9. Remove plug (8) for the charge relief valve.



Illustration 6

g00903502

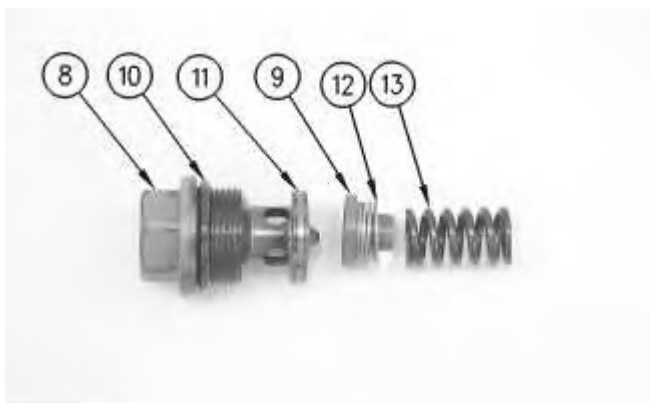

Illustration 7

g00903503

10. Remove seat (9).
11. Remove shims (12).
12. Remove spring (13).
13. Remove seal (11) from plug (8).

14. Remove O-ring seal (10) from plug (8).

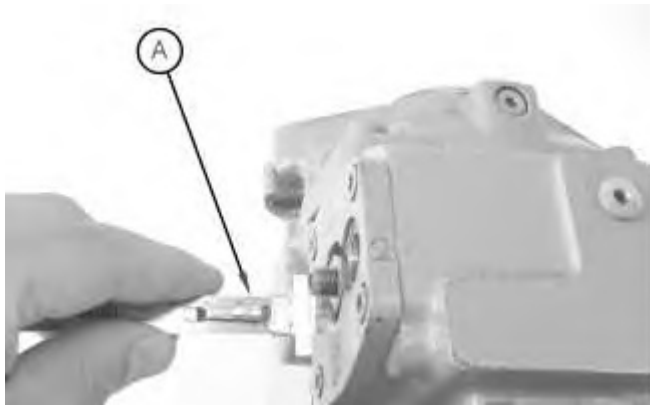

Illustration 8

g01178122

15. Use Tooling (A) to measure the distance from the stud to the nut. Record the distance for assembly purposes.

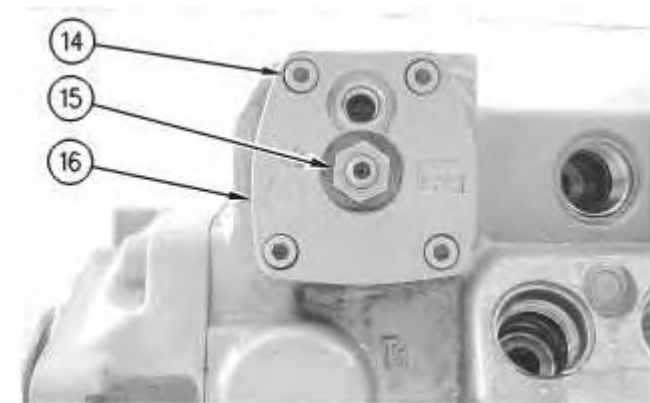

Illustration 9

g00904929

16. Remove screws (14).
17. Remove nut (15).
18. Remove cover (16).



19. Remove O-ring seal (17) from cover (16).



Illustration 11

20. Use Tooling (B) to remove retaining ring (18). Remove actuator assembly (19).

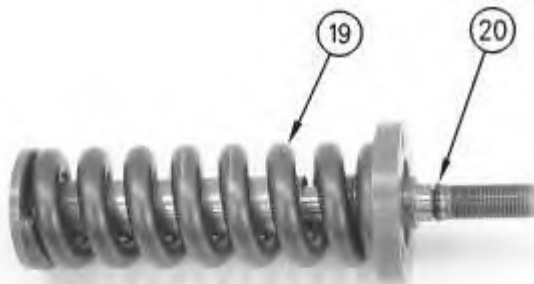

Illustration 12

21. Remove O-ring seal (20) from actuator assembly (19).

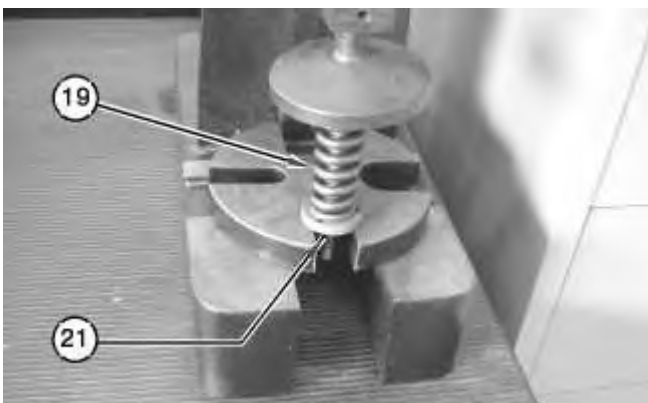

Illustration 13

WARNING

Personal injury can result from being struck by parts propelled by a released spring force.

Make sure to wear all necessary protective equipment.

Follow the recommended procedure and use all recommended tooling to release the spring force.

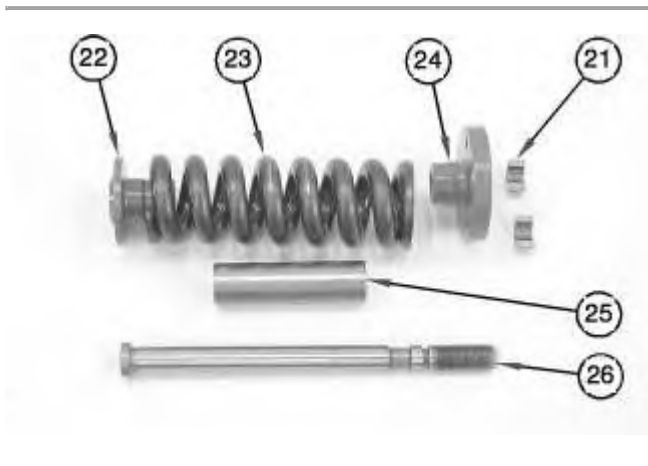

Illustration 14

g01054370

Note: Keepers (21) must be marked for assembly. Do not mix keepers (21). The keepers are not interchangeable.

22. Place actuator assembly (19) in a suitable press.
 23. Remove keepers (21).
 24. Remove shaft (26).
 25. Remove spring retainer (22).
 26. Remove spring (23).
 27. Remove spring retainer (24).
 28. Remove spacer (25).
 29. Repeat Step 15 through Step 28 for the other cover.
-

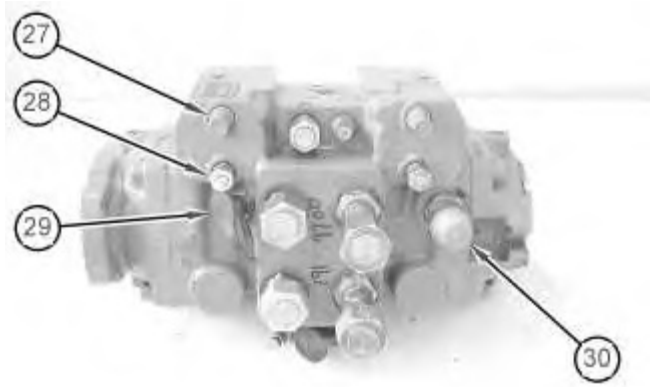

Illustration 15

g01178123

30. Remove caps (27).
31. Remove connectors (28).
32. Remove fitting (29).
33. Remove adapter (30).

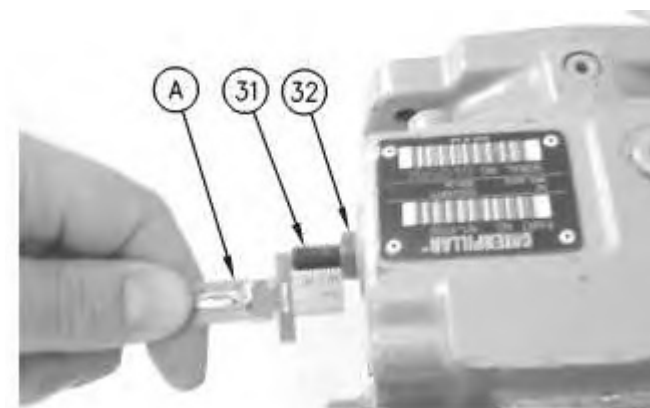

Illustration 16

g00905035

Note: Mark the location of the notch in stud (31) by making a corresponding mark on the housing for installation purposes.

34. Use Tooling (A) to measure the distance from stud (31) to nut (32). Record the distance for assembly purposes.
35. Remove stud (31) and nut (32).
36. Repeat Step 34 and Step 35 for the other stud.

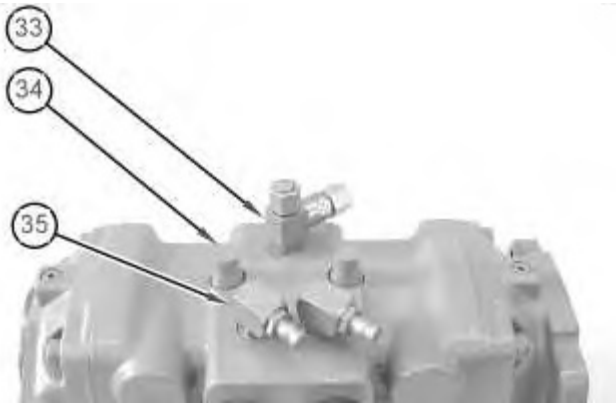

Illustration 17

g01178125

37. Remove connector (33).
38. Remove caps (34).
39. Remove fittings (35).

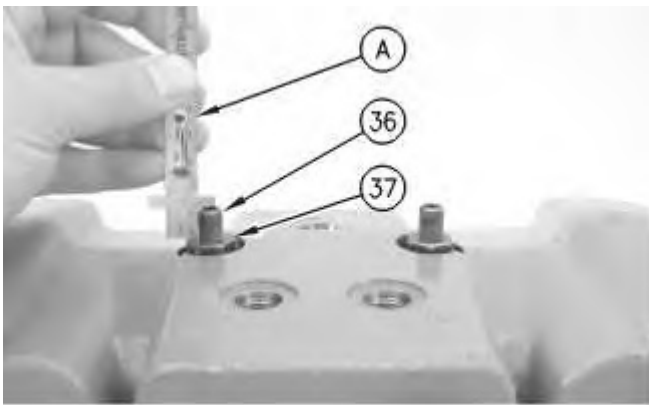
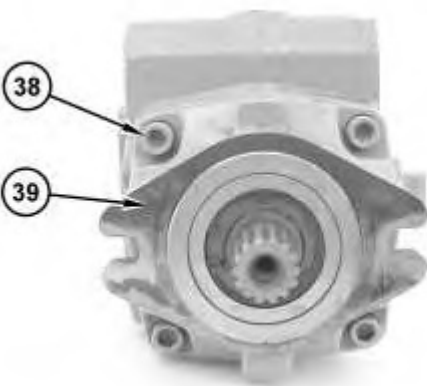

Illustration 18

g00905224

40. Use Tooling (A) to measure the distance from studs (36) to nuts (37). Record the distance for assembly purposes.
41. Remove studs (36) and nuts (37).



42. Remove bolts (38) from cover (39).



Illustration 20

43. Use a suitable lifting device, Tooling (C), Tooling (D), and Tooling (E) to raise the piston pump housing.



Illustration 21

Note: Mark the port plates for assembly. Port plates are not interchangeable.

44. Remove port plate (40).



45. Remove plug (41) and the O-ring seal.
-



Illustration 23

46. Remove slotted pin (42).
47. Repeat Step 45 and Step 46 for the other side.
-

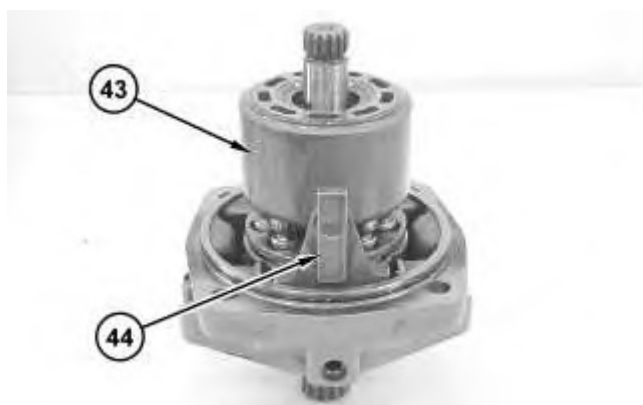

Illustration 24

48. Remove the rotating assembly and swashplate (43).
49. Remove linkage (44).
-



Download the full PDF manual instantly.

Our customer service e-mail:

aservicemanualpdf@yahoo.com