

BKIDA5076 >> R065 >> MOTOR / ENGINE >> 502000 ZYLINDERKOPF / CYLINDER HEAD

Update Date : 2020/03/12 Print Date : 2022/03/29

No.	Part Number	Part Name (POL)	Part Name (ENG)	QTY	IC	Serial No./PIN	Kg	Remarks
010	1J730-01740	MOTORHAKE N	HOOK,ENGIN E	1			0.250	
020	1J730-01750	MOTORHAKE N	HOOK,ENGIN E	1			0.200	
030	01754-50816	SCHRAUBE	BOLT,FLANG E	4			0.011	
040	1J701-03034	GRP.ZYLINDE RKOPF	ASSY CYLINDER HEAD	1		<=8GVZ999	25.000	ORDER BY REF.No.040 NEW PART
040	1J701-03036	GRP.ZYLINDE RKOPF	ASSY CYLINDER HEAD	1	>>	>=8GW0001	21.015	
050	15521-96020	STOPFEN	PLUG	1			0.003	
060	15321-96260	KAPPE	CAP,SEALING	1			0.014	
070	16851-96270	KAPPE	CAP,SEALING	8			0.005	
080	16683-96020	STOPFEN	PLUG	1			0.088	
090	1J700-04560	BOLZEN	BOLT,CRANK CASE	10			0.145	
100	1J700-03310	ZYLINDERKO PFDICHTUNG	GASKET,CYLI NDER HEAD	1		<=8JKZ999	0.165	0.1mm
100	1J700-03313	ZYLINDERKO PFDICHTUNG	GASKET,CYLI NDER HEAD	1	>>	>=8JL0001	0.165	0.1mm
100	1J700-03320	ZYLINDERKO PFDICHTUNG	GASKET,CYLI NDER HEAD	1		<=8JKZ999	0.190	0.2mm
100	1J700-03323	ZYLINDERKO PFDICHTUNG	GASKET,CYLI NDER HEAD	1	>>	>=8JL0001	0.190	0.2mm
100	1J700-03330	ZYLINDERKO PFDICHTUNG	GASKET,CYLI NDER HEAD	1		<=8JKZ999	0.220	0.3mm
100	1J700-03333	ZYLINDERKO PFDICHTUNG	GASKET,CYLI NDER HEAD	1	>>	>=8JL0001	0.220	0.3mm

Update Date : 2020/03/12 Print Date : 2022/03/29

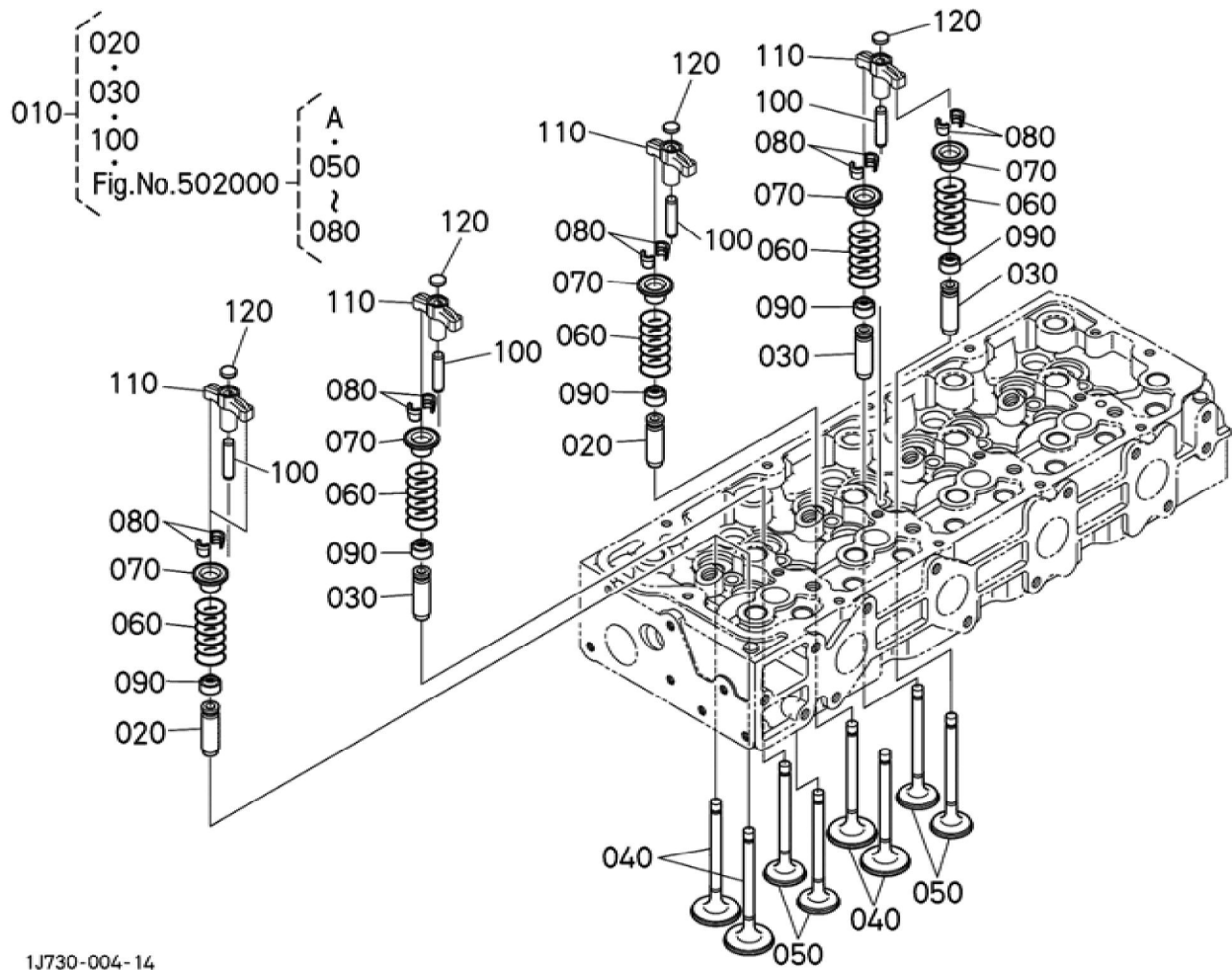

1J730-004-14

Update Date : 2020/03/12 Print Date : 2022/03/29

No.	Part Number	Part Name (POL)	Part Name (ENG)	QTY	IC	Serial No./PIN	Kg	Remarks
010	1J701-03034	GRP.ZYLINDERKOPF	ASSY CYLINDER HEAD	1		<=8GVZ999	25.000	ORDER BY REF.No.010 NEW PART
010	1J701-03036	GRP.ZYLINDERKOPF	ASSY CYLINDER HEAD	1	>>	>=8GW0001	21.015	
020	1J700-13540	EINLASSVENTILFUEHRUNG	GUIDE,VALVE ,INLET	8			0.014	
030	1J700-13560	AUSLASSVENTILFUEHRUNG	GUIDE,VALVE ,EXHAUST	8			0.014	
040	1J700-13110	EINLASSVENTIL	VALVE,INLET	8		<=8HHZ999	0.040	
040	1J700-13113	VENTIL	VALVE,INLET	8	>>	>=8HJ0001	0.040	
050	1J700-13120	AUSLASSVENTIL	VALVE,EXHAUST	8		<=8HHZ999	0.035	
050	1J700-13123	AUSLASSVENTIL	VALVE,EXHAUST	8	>>	>=8HJ0001	0.035	
060	1J700-13240	VENTIL-FEDER	SPRING,VALVE	16		<=8HRZ999	0.018	
060	1J705-13240	VENTIL-FEDER	SPRING	16	NI	>=8HS0001	0.010	
070	14601-13330	FEDER, HALTEBUEGEL	RETAINER (VALVE SPRING)	16			0.010	
080	14601-13980	KLEMMSCHEIBE	COLLET,VALVE SPRING	16			0.001	SET
090	11420-13150	VENTILDICHTUNG	SEAL (VALVE STEM)	16			0.002	
100	1J700-13480	WELLE	SHAFT,VALVE	8			0.016	
110	1J700-13462	HUBARM, VENTIL	ARM,VALVE BRIGE	8		<=8HBZ999	0.039	
110	1J700-13463	HUBARM, VENTIL	ARM,VALVE BRIGE	8	>>	>=8HC0001	0.039	
110	1J705-13460	HUBARM, VENTIL	ARM	8	NI	>=8HS0001	0.040	
120	1J700-13492	PUFFER	PAD	8			0.003	

Update Date : 2020/03/12 Print Date : 2022/03/29

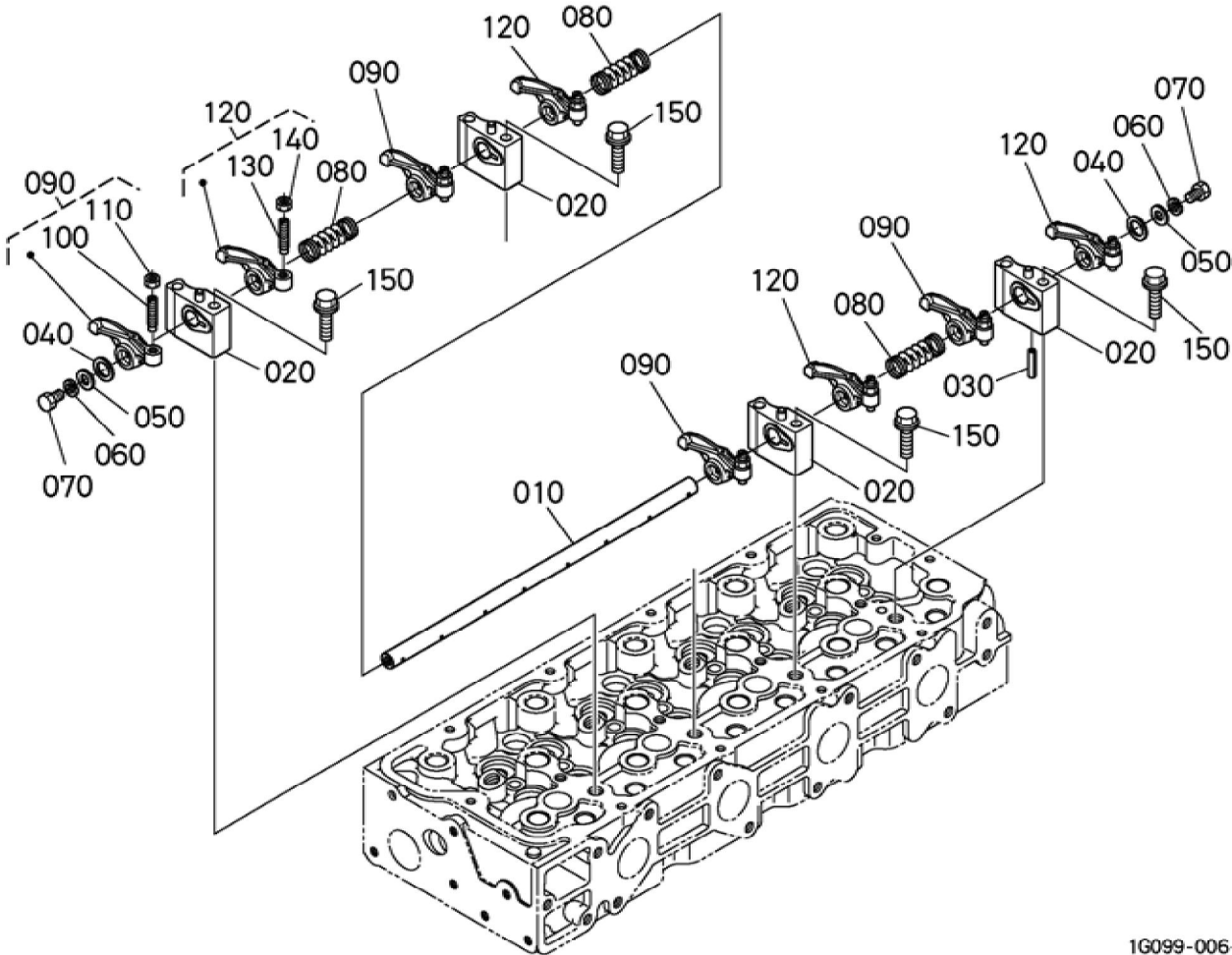



Download the full PDF manual instantly.

Our customer service e-mail:

aservicemanualpdf@yahoo.com