

BKIDK0637 >> M8540DTHC >> MOTOR / ENGINE >> 200000 KURBELGEHAEUSE / CRANKCASE

Update Date : 2018/02/26 Print Date : 2022/04/14

No.	Part Number	Part Name (POL)	Part Name (ENG)	QTY	IC	Serial No./PIN	Kg	Remarks
010	1J597-01010	KOMP.KURBELGEHAEUSE	COMP.CRANKCASE	1		<=2DFZ999	72.000	
010	1J597-01014	KOMP.KURBELGEHAEUSE	COMP.CRANKCASE	1	>>	>=2DG0001	72.000	
020	15521-96020	STOPFEN	PLUG	2		<=BHZ999	0.003	
020	15521-96020	STOPFEN	PLUG	3		>=BJ0001	0.003	
030	1C010-96010	STOPFEN	PLUG	1			0.012	
040	16683-96020	STOPFEN	PLUG	1			0.088	
050	15261-03370	STOEPSSEL, ABDICHTUNG	CAP,SEALING	4			0.005	
060	15221-03380	STOPFEN	CAP,SEALING	5			0.017	
065	15221-03380	STOPFEN	CAP,SEALING	2			0.017	
070	15221-03390	STOPFEN	CAP,SEALING	1			0.030	
080	1C010-96160	STOPFEN	PLUG,EXPANSION	1			0.050	
090	05012-00820	ZYLINDERSTIFT	PIN,STRAIGHT	1			0.008	
100	05012-01016	ZYLINDERSTIFT	PIN STRAIGHT	2			0.010	
110	15221-33650	ROHRSTIFT	PIN,PIPE	2			0.004	
120	1C010-33640	STIFT	PIN,GEAR CASE	1		<=9Y2374	0.019	
120	1C010-33643	STIFT	PIN,STRAIGHT	1	>>	>=AA0001	0.019	
130	1C010-04560	BOLZEN	BOLT,BEARING CASE	10			0.130	
140	1G513-36550	STOPFEN, OELMESSSTAB	PLUG,OIL GAUGE	1			0.004	
150	1C040-33212	STIFT	PIPE,OIL	1			0.025	
155	1J574-71362	ADAPTER	JOINT,PIPE	1		<=8S4317	0.210	
155	1J550-71350	ROHRSCHALTUNG	JOINT,PIPE	1	>>	>=8U0001	0.100	BESTELLEN SIE BITTE POS.155 NEUE TEILE
155	1J550-71352	ROHRSCHALTUNG	JOINT,PIPE	1	>>	>=9E0001	0.100	
160	1C010-37114	ADAPTER, WASSERROHR	JOINT,WATER PIPE	1			0.020	

BKIDK0637 >> M8540DTHC >> MOTOR / ENGINE >> 200000 KURBELGEHAUSE / CRANKCASE

Update Date : 2018/02/26 Print Date : 2022/04/14

No.	Part Number	Part Name (POL)	Part Name (ENG)	QTY	IC	Serial No./PIN	Kg	Remarks
170	06311-55030	STOPFEN	PLUG	1			0.050	
180	04724-00170	DICHTUNGSP LATTE	GASKET	1			0.005	
190	1C012-01120	KURBELGHA EUSE	CRANKCASE	1		<=2DFZ999	44.050	
190	1C012-01124	KURBELGHA EUSE	CRANKCASE	1	>>	>=2DG0001	44.050	
200	1C010-33650	STIFT	PIN,STRAIGH T (CASE,GEAR)	1		<=AQ2757	0.037	
200	1C010-33653	STIFT	PIN,STRAIGH T	1	>>	>=AS0001	0.037	
205	1C011-94510	ZYLINDERSTI FT	PIN,STRAIGH T	2			0.040	
210	1C010-33080	BLINDSTOPF EN	ASSY PLUG,O/FILL ER	1			0.018	
220	E9151-33140	OELEINFUEL LSTOPFEN	PLUG(OIL FILLER)	1			0.017	
230	04817-50300	O RING	O RING	1			0.001	
240	15602-33110	EINFUELLFLA NSCH	FLANGE,OIL FILLER	1			0.100	
250	15625-32890	DICHTUNGSP LATTE	GASKET	1			0.001	
260	01754-50820	SCHRAUBE	BOLT,FLANG E	2			0.015	
270	1C011-91012	SCHRAUBE	BOLT,FLANG E	2			0.100	

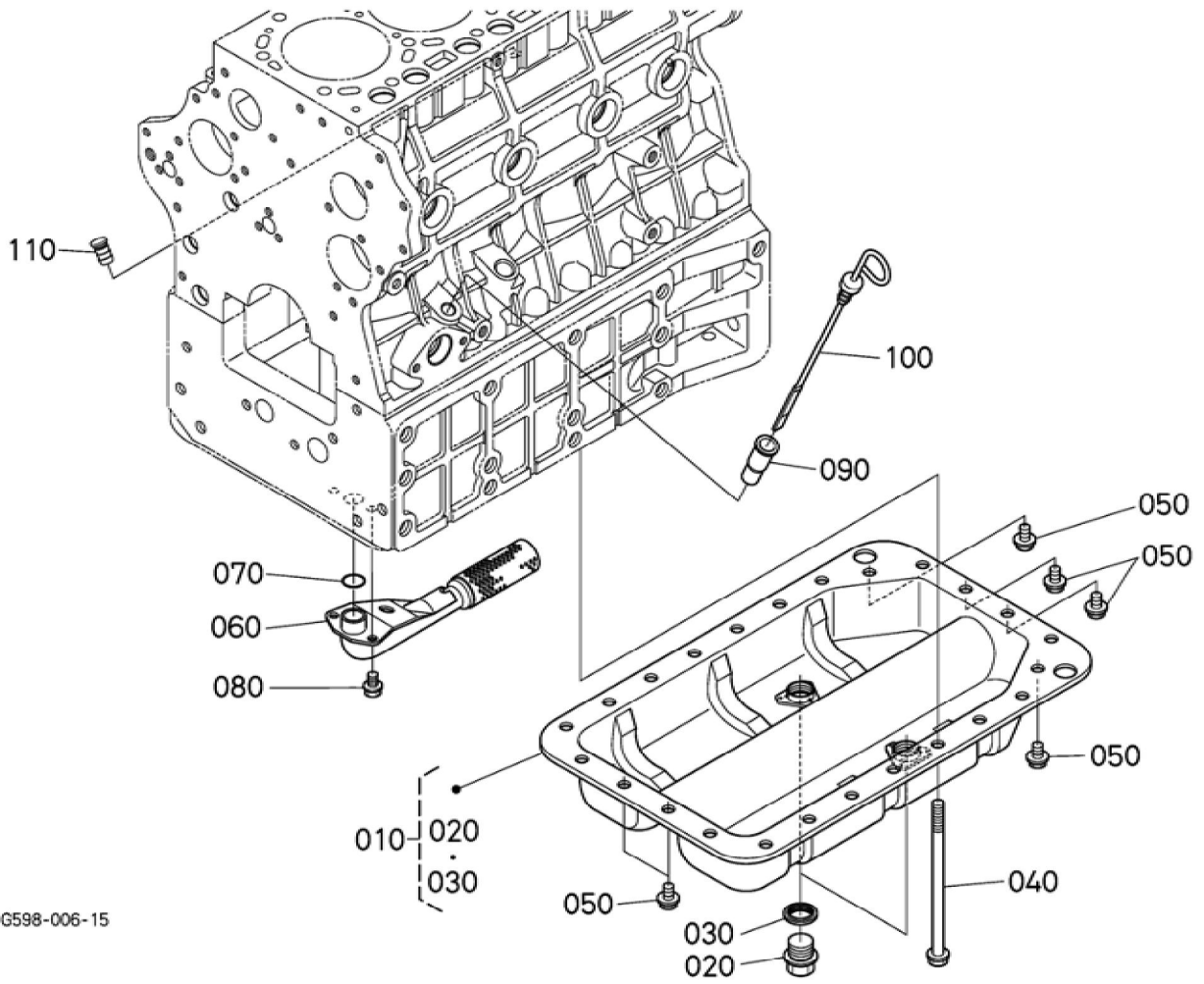

BKIDK0637 >> M8540DTHC >> MOTOR / ENGINE >> 201000 OELWANNE / OIL PAN

Update Date : 2018/02/26 Print Date : 2022/04/14

No.	Part Number	Part Name (POL)	Part Name (ENG)	QTY	IC	Serial No./PIN	Kg	Remarks
010	1G511-01605	KOMP. OELWANNE	PAN,OIL,KIT	1			2.430	
020	15707-33750	ENTLEERUN GSSTOPFEN	PLUG(DRAIN)	2			0.095	
030	16265-96670	DICHTUNG	PACKING	2			0.010	
040	1C011-91012	SCHRAUBE	BOLT,FLANG E	18			0.100	
050	1C010-91100	BOLZEN	BOLT,OILPAN	6			0.020	
060	1C011-32110	OELFILTER	FILTER(OIL)	1			0.280	
070	04814-00220	O RING	O RING	1			0.001	
080	01754-50814	SCHRAUBE	BOLT,FLANG E	2		<=AQ2757	0.012	
080	01754-50812	SCHRAUBE	BOLT,FLANG E	2	>>	>=AS0001	0.010	
090	1C010-36422	FUEHRUNG, OELMESSST AB	GUIDE,OIL GAUGE	1			0.014	
100	1C010-36412	OELMESSST AB	GAUGE,OIL	1			0.040	
110	1G513-36550	STOPFEN, OELMESSST AB	PLUG,OIL GAUGE	1			0.004	

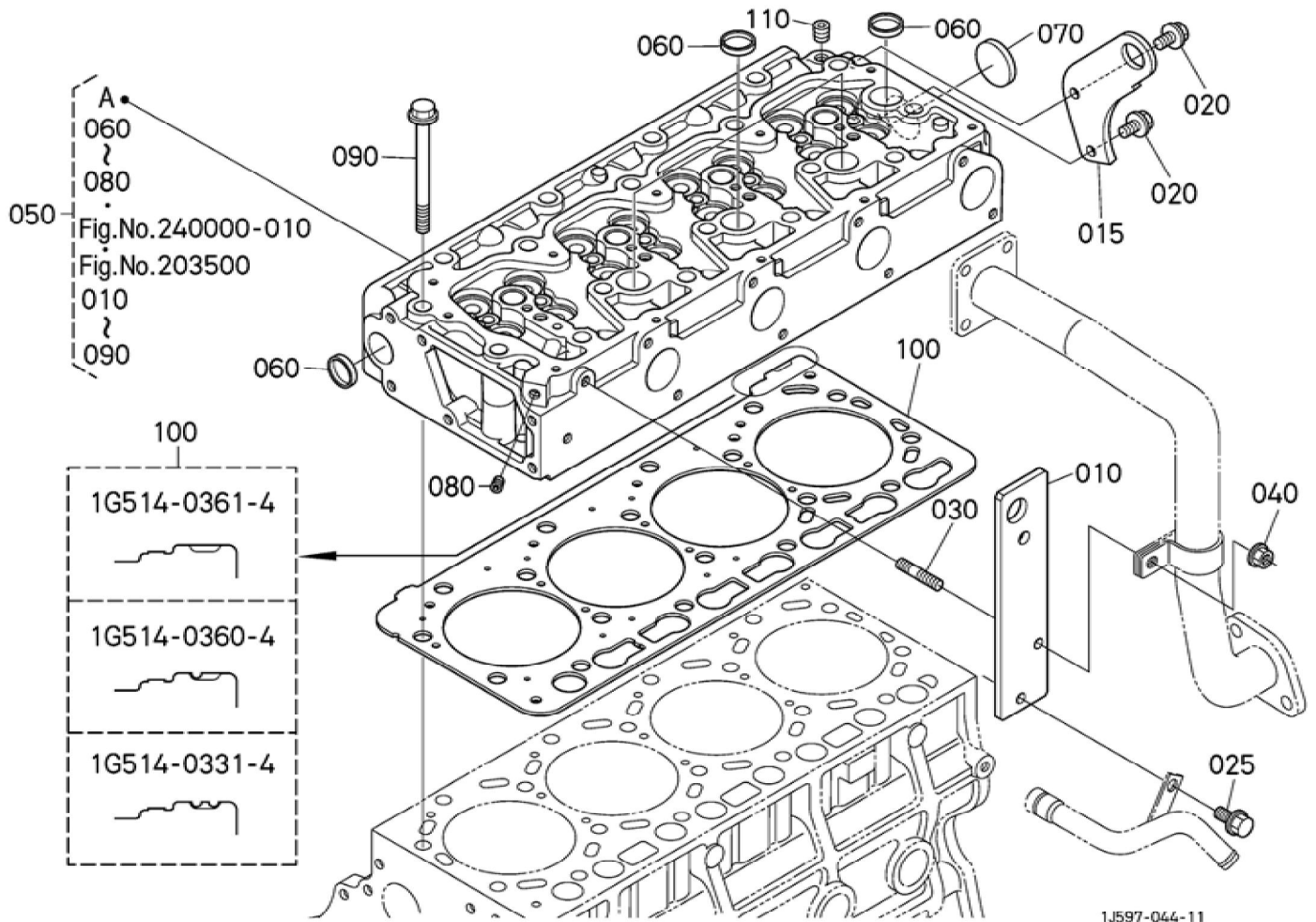

BKIDK0637 >> M8540DTHC >> MOTOR / ENGINE >> 202000 ZYLINDERKOPF / CYLINDER HEAD

Update Date : 2018/02/26 Print Date : 2022/04/14

No.	Part Number	Part Name (POL)	Part Name (ENG)	QTY	IC	Serial No./PIN	Kg	Remarks
010	1J574-01740	MOTORAUFH AENGUNG	HOOK,ENGIN E	1		<=9N1404	0.430	
010	1J574-01743	MOTORAUFH AENGUNG	HOOK,ENGIN E	1	NI	>=9Q0001	0.430	
015	15471-01740	MOTORHAKE N	HOOK,ENGIN E	1			0.180	
020	01754-50814	SCHRAUBE	BOLT,FLANG E	2			0.012	
025	01754-50818	SCHRAUBE	BOLT,FLANG E	1		<=CFZ999	0.011	
025	1J500-91020	SCHRAUBE	BOLT,FLANG E	1	>>	>=CG0001	0.012	
030	15221-91530	STEBBOLZEN	BOLT,STUD	1		<=CBZ999	0.010	
030	1J542-91632	STEBBOLZEN	STUD	1	>>	>=CC0001	0.011	
040	02751-50080	MUTTER	NUT,FLANGE	1			0.006	
050	1C020-03027	GRP.ZYLINDE RKOPF	HEAD,CYL,AS SY	1		<=AG2611	26.000	
050	1C020-03029	GRP.ZYLINDE RKOPF	ASSY CYLINDER HEAD	1	>>	>=AJ0001	26.000	
050	1C050-03020	GRP.ZYLINDE RKOPF	HEAD,CYLIN DER,ASSY	1	>>	>=2EN0001	25.000	
060	15221-03370	STOPFEN	PLUG,CUP TYPE	5			0.010	
070	15221-03490	STOPFEN	CAP,SEALING	1			0.020	
080	15521-96020	STOPFEN	PLUG	1			0.003	
090	1C010-03450	ZYLINDERKO PFSCHRAUB E	BOLT,CYLIND ER HEAD	18			0.100	
100	1G514-03310	ZYLINDERKO PFDICHTUNG	GASKET,CYLI NDER HEAD	1		<=CHZ999	0.230	STD/2 KERBEN
100	1G514-03313	ZYLINDERKO PFDICHTUNG	GASKET (HEAD,CYL)	1	>>	>=CJ0001	0.230	STD/2 KERBEN
100	1G514-03314	ZYLINDERKO PFDICHTUNG	GASKET,CYL. HEAD	1	>>	>=2DC0001	0.230	STD/2 KERBEN
100	1G514-03602	ZYLINDERKO PFDICHTUNG	GASKET,CYL. HEAD	1		<=CHZ999	0.260	VERWENDUN G / 1 KERBE
100	1G514-03603	ZYLINDERKO PFDICHTUNG	GASKET (HEAD,CYL)	1	>>	>=CJ0001	0.260	VERWENDUN G / 1 KERBE

BKIDK0637 >> M8540DTHC >> MOTOR / ENGINE >> 202000 ZYLINDERKOPF / CYLINDER HEAD

Update Date : 2018/02/26 Print Date : 2022/04/14

No.	Part Number	Part Name (POL)	Part Name (ENG)	QTY	IC	Serial No./PIN	Kg	Remarks
100	1G514-03604	ZYLINDERKO PFDICHTUNG	GASKET,CYL. HEAD	1	>>	>=2DC0001	0.260	VERWENDUN G / 1 KERBE
100	1G514-03612	ZYLINDERKO PFDICHTUNG	GASKET,CYL. HEAD	1		<=CHZ999	0.270	VERWENDUN G / KEINE KERBE
100	1G514-03613	ZYLINDERKO PFDICHTUNG	GASKET (HEAD,CYL)	1	>>	>=CJ0001	0.270	VERWENDUN G / KEINE KERBE
100	1G514-03614	ZYLINDERKO PFDICHTUNG	GASKET,CYL. HEAD	1	>>	>=2DC0001	0.270	VERWENDUN G / KEINE KERBE
110	15841-96020	STOPFEN	PLUG	1			0.020	

Update Date : 2018/02/26 Print Date : 2022/04/14

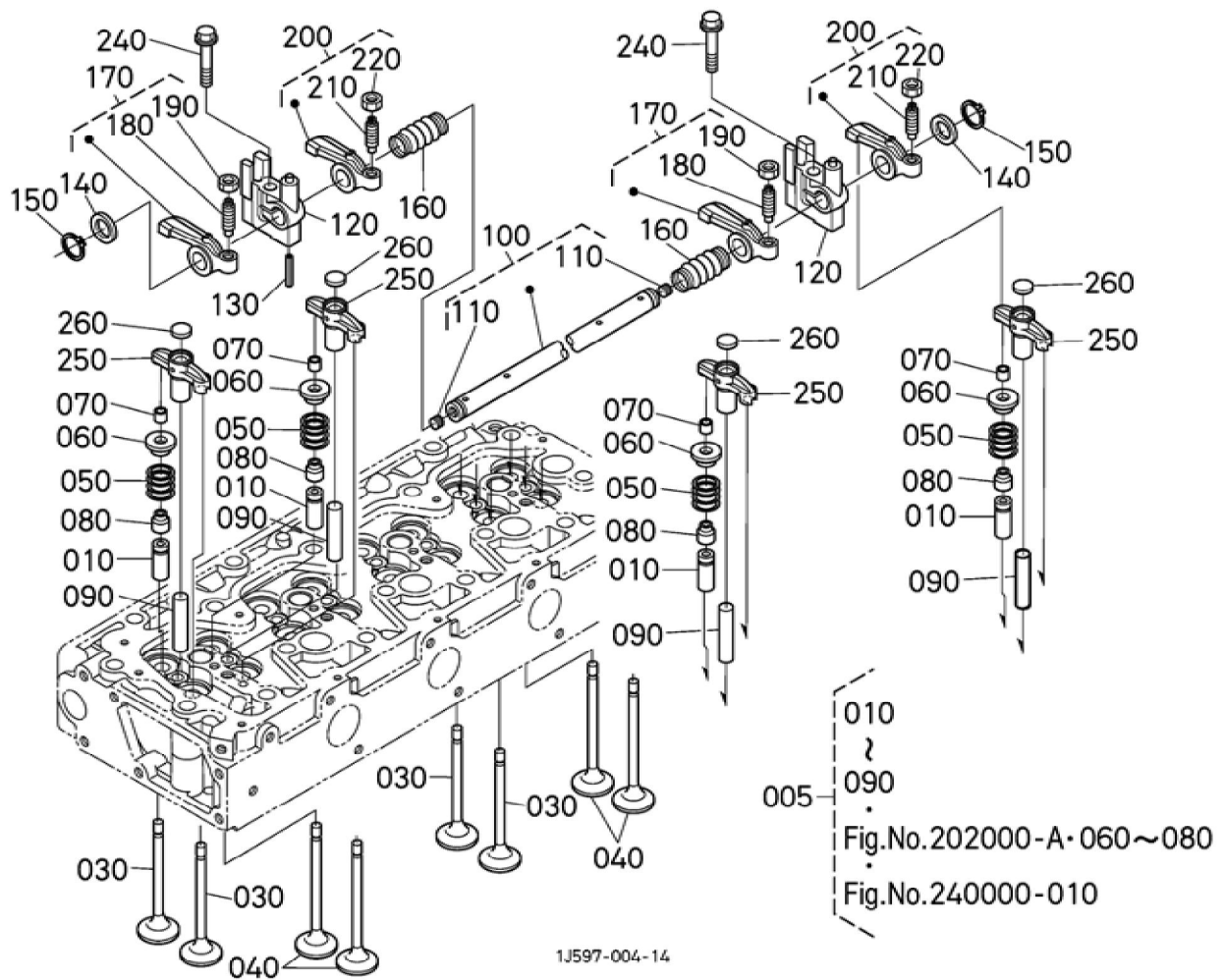



Download the full PDF manual instantly.

Our customer service e-mail:

aservicemanualpdf@yahoo.com