

Update Date : 11-07-2019 Print Date : 12-04-2022

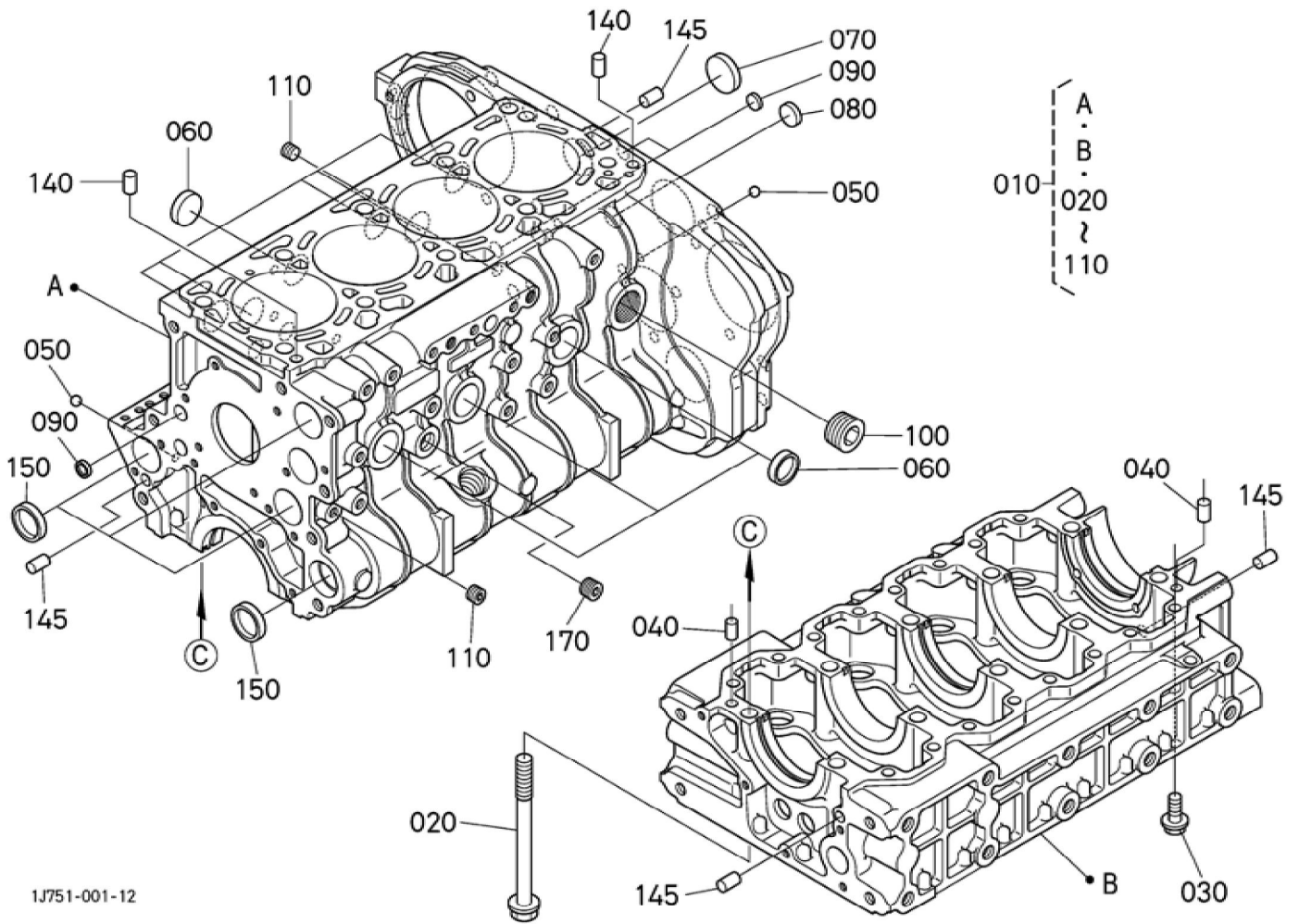

1J751-001-12

> MOTOR / ENGINE >> 300001 KURBELGEHAEUSE [ALTER] / CRANKCASE [OLD] ## S.Nr.<=8CRZ999 S.No.;<=8CRZ999 / S.No.

Update Date : 11-07-2019 Print Date : 12-04-2022

| No. | Part Number | Part Name (POL) | Part Name (ENG) | QTY | IC | Serial No./PIN | Kg | Remarks |
|-----|-------------|----------------------------|-------------------|-----|----|----------------|-------|---------|
| 010 | 1J751-01020 | GRP. KURBELGEH AEUSE | ASSY CRANKCASE | 1 | | | 0.001 | |
| 020 | 1G772-03450 | BOLZEN | BOLT | 10 | | | 0.175 | |
| 030 | 1G772-91022 | SCHRAUBE | BOLT,FLANG E | 16 | | | 0.035 | |
| 040 | 05012-01016 | ZYLINDERSTI FT | PIN STRAIGHT | 2 | | | 0.010 | |
| 050 | 07715-03209 | KUGEL | BALL | 2 | | | 0.002 | |
| 060 | 15321-96260 | KAPPE | CAP,SEALING | 9 | | | 0.014 | |
| 070 | 15221-03490 | STOPFEN | CAP,SEALING | 1 | | | 0.020 | |
| 080 | 16851-96270 | KAPPE | CAP,SEALING | 1 | | | 0.005 | |
| 090 | 06311-85016 | STOEPSEL,A BDICHTUNG | CAP,SEALING | 3 | | | 0.003 | |
| 100 | 16683-96020 | STOPFEN | PLUG | 1 | | | 0.088 | |
| 110 | 15521-96020 | STOPFEN | PLUG | 2 | | | 0.003 | |
| 140 | 05012-01016 | ZYLINDERSTI FT | PIN STRAIGHT | 6 | | <=AG1207 | 0.010 | |
| 140 | 05012-01016 | ZYLINDERSTI FT | PIN STRAIGHT | 2 | | >=AJ0001 | 0.010 | |
| 145 | 1G772-94520 | ZYLINDERSTI FT | PIN,STRAIGH T | 4 | | >=AJ0001 | 0.010 | |
| 150 | 15221-03490 | STOPFEN | CAP,SEALING | 4 | | | 0.020 | |
| 170 | 06311-55030 | STOPFEN | PLUG | 1 | | <=AC0734 | 0.050 | |
| 170 | 1A021-96020 | STOPFEN | PLUG | 1 | >> | >=AE0001 | 0.020 | |

Update Date : 11-07-2019 Print Date : 12-04-2022

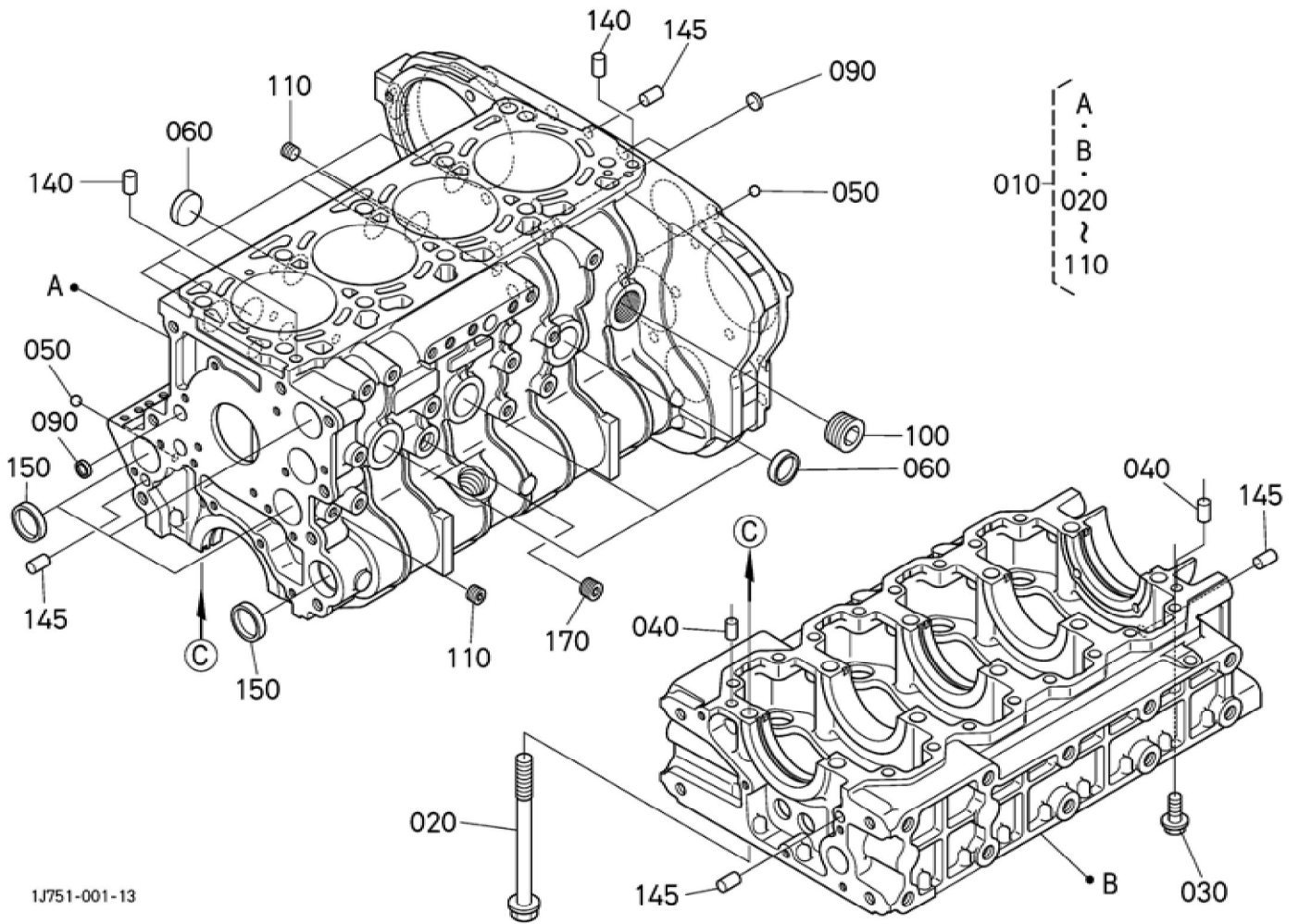

1J751-001-13

>> MOTOR / ENGINE >> 300002 KURBELGEHAEUSE [NEU] / CRANKCASE [NEW] ## S.Nr.>=8CS0001 S.No.;>=8CS0001 / S.No.>

Update Date : 11-07-2019 Print Date : 12-04-2022

| No. | Part Number | Part Name (POL) | Part Name (ENG) | QTY | IC | Serial No./PIN | Kg | Remarks |
|-----|-------------|----------------------------|-------------------|-----|----|----------------|--------|---------|
| 010 | 1J751-01023 | GRP. KURBELGEH AEUSE | ASSY CRANKCASE | 1 | | | 94.000 | |
| 020 | 1G772-03450 | BOLZEN | BOLT | 10 | | | 0.175 | |
| 030 | 1G772-91022 | SCHRAUBE | BOLT,FLANG E | 16 | | | 0.035 | |
| 040 | 05012-01016 | ZYLINDERSTI FT | PIN STRAIGHT | 2 | | | 0.010 | |
| 050 | 07715-03209 | KUGEL | BALL | 2 | | | 0.002 | |
| 060 | 15321-96260 | KAPPE | CAP,SEALING | 9 | | | 0.014 | |
| 090 | 06311-85016 | STOEPSEL,A BDICHTUNG | CAP,SEALING | 3 | | | 0.003 | |
| 100 | 16683-96020 | STOPFEN | PLUG | 1 | | | 0.088 | |
| 110 | 15521-96020 | STOPFEN | PLUG | 2 | | | 0.003 | |
| 140 | 05012-01016 | ZYLINDERSTI FT | PIN STRAIGHT | 2 | | | 0.010 | |
| 145 | 1G772-94520 | ZYLINDERSTI FT | PIN,STRAIGH T | 4 | | | 0.010 | |
| 150 | 15221-03490 | STOPFEN | CAP,SEALING | 4 | | | 0.020 | |
| 170 | 1A021-96020 | STOPFEN | PLUG | 1 | | | 0.020 | |

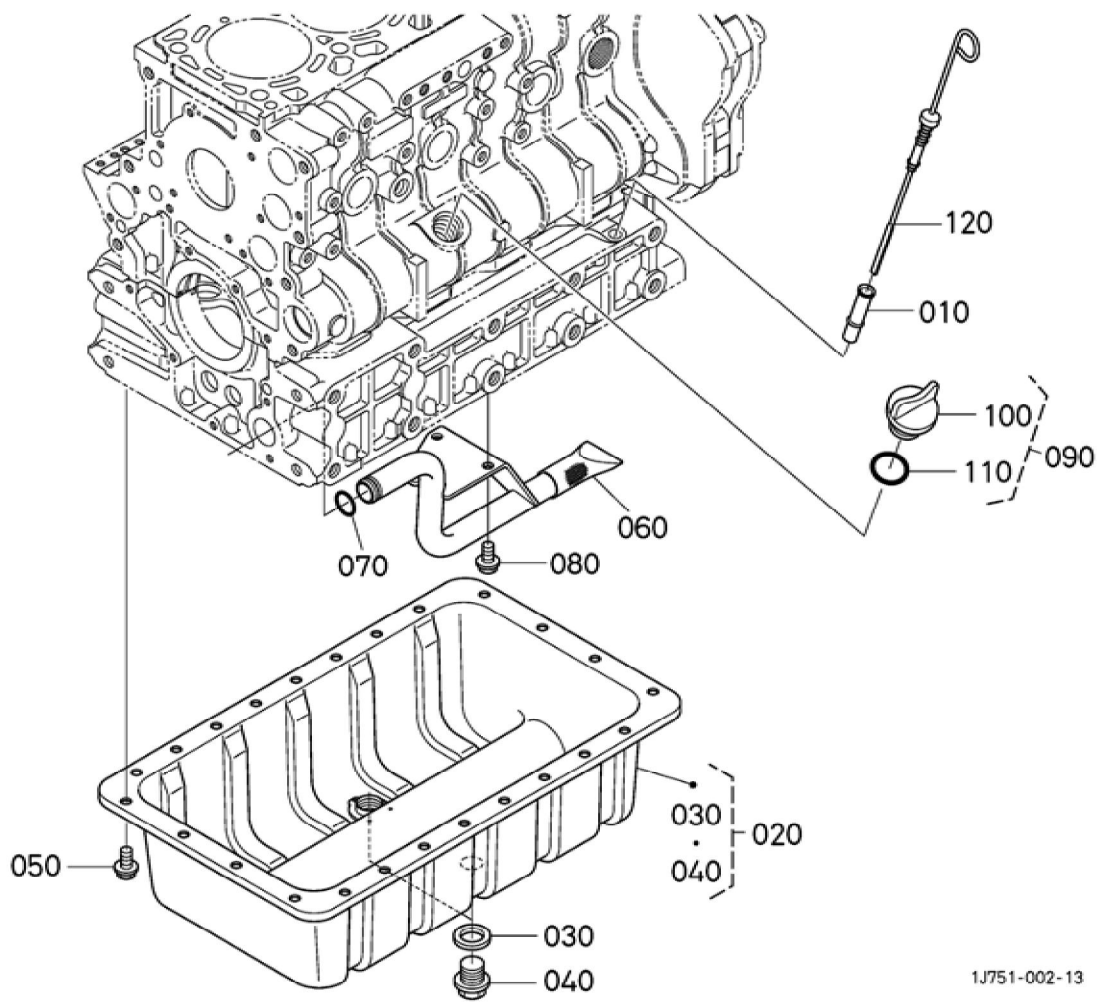

BKIDK0641 >> M6040DTH >> MOTOR / ENGINE >> 301001 OELWANNE / OIL PAN

Update Date : 11-07-2019 Print Date : 12-04-2022

| No. | Part Number | Part Name (POL) | Part Name (ENG) | QTY | IC | Serial No./PIN | Kg | Remarks |
|-----|-------------|------------------------------|---------------------------|-----|----|----------------|-------|---------|
| 010 | 16809-36420 | FUEHRUNG, OELMESSST AB | GUIDE (GAUGE,OIL) | 1 | | | 0.028 | |
| 020 | 1G772-01660 | GRP.OELWA NNE | KIT OIL PAN | 1 | | | 4.000 | |
| 030 | 16265-96670 | DICHTUNG | PACKING | 2 | | | 0.010 | |
| 040 | 15707-33750 | ENTLEERUN GSSTOPFEN | PLUG(DRAIN) | 2 | | | 0.095 | |
| 050 | 01755-50816 | SCHRAUBE | BOLT,FLANG E | 24 | | | 0.013 | |
| 060 | 1G772-32110 | OELFILTER | FILTER,OIL | 1 | | <=8N1300 | 0.510 | |
| 060 | 1G772-32114 | OELFILTER | FILTER,OIL | 1 | >> | >=8Q0001 | 0.415 | |
| 070 | 04815-00200 | O RING | O RING | 1 | | | 0.003 | |
| 080 | 01755-50816 | SCHRAUBE | BOLT,FLANG E | 2 | | | 0.013 | |
| 090 | 1C010-33080 | BLINDSTOPF EN | ASSY PLUG,O/FILL ER | 1 | | | 0.018 | |
| 100 | E9151-33140 | OELEINFUEL LSTOPFEN | PLUG(OIL FILLER) | 1 | | | 0.017 | |
| 110 | 04817-50300 | O RING | O RING | 1 | | | 0.001 | |
| 120 | 1G774-36410 | OELMESSST AB | GAUGE,OIL | 1 | | | 0.025 | |

Update Date : 11-07-2019 Print Date : 12-04-2022

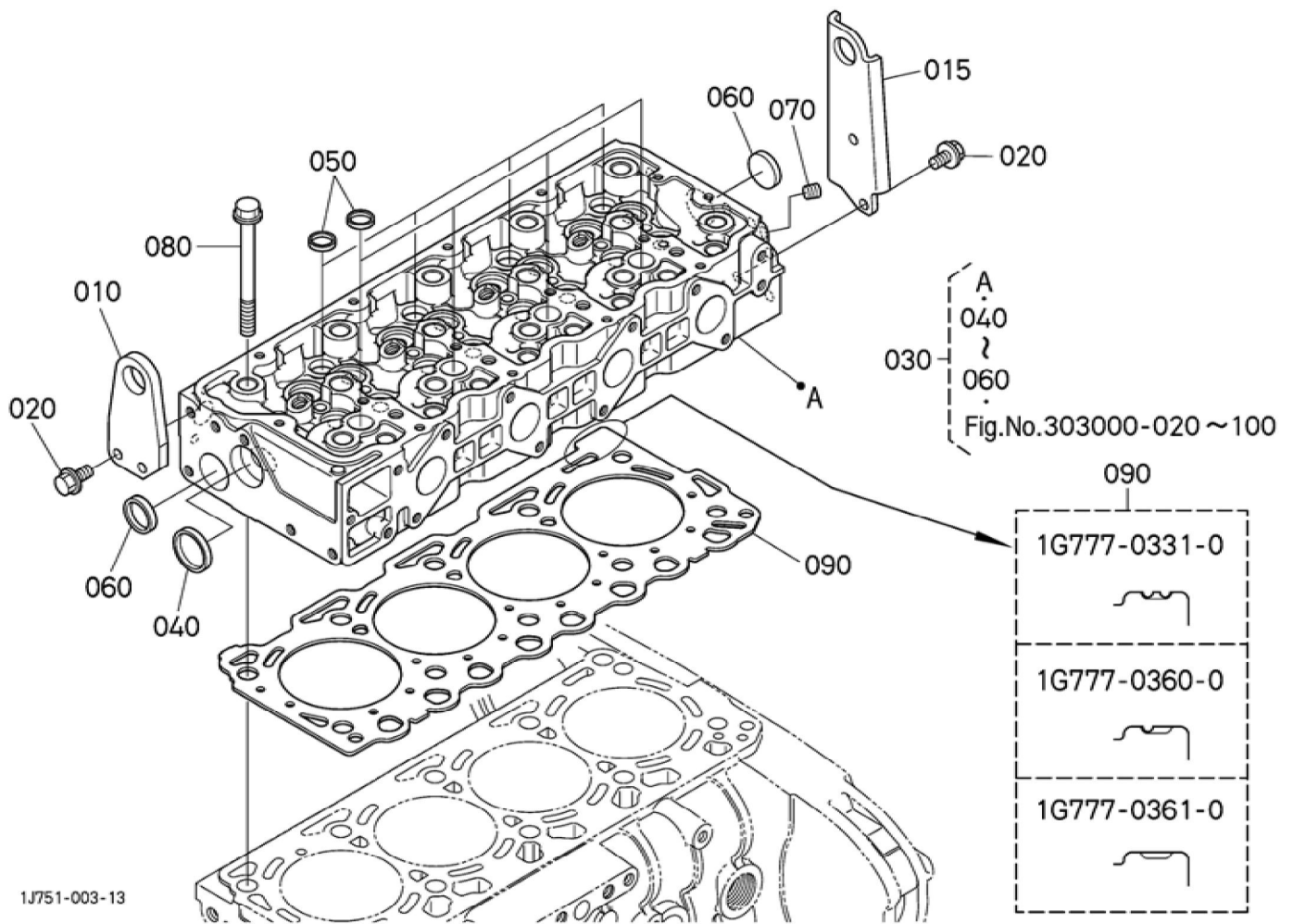

Update Date : 11-07-2019 Print Date : 12-04-2022

| No. | Part Number | Part Name (POL) | Part Name (ENG) | QTY | IC | Serial No./PIN | Kg | Remarks |
|-----|-------------|--------------------------|--------------------------|-----|----|----------------|--------|---------------------------------|
| 010 | 1G777-01744 | MOTORHAKE N | HOOK,ENGIN E | 1 | | | 0.300 | |
| 015 | 1G777-01754 | MOTORHAKE N | HOOK,ENGIN E | 1 | | | 0.515 | |
| 020 | 01754-50816 | SCHRAUBE | BOLT,FLANG E | 4 | | | 0.011 | |
| 030 | 1G777-03020 | GRP.ZYLINDE RKOPF | ASSY CYLINDER HEAD | 1 | | <=AXZ999 | 25.900 | SEE NOTE |
| 030 | 1G777-03022 | GRP.ZYLINDE RKOPF | ASSY CYLINDER HEAD | 1 | NI | >=AY0001 | 23.500 | |
| 040 | 15221-03490 | STOPFEN | CAP,SEALING | 2 | | <=BTZ999 | 0.020 | |
| 040 | 15221-03490 | STOPFEN | CAP,SEALING | 1 | | >=BU0001 | 0.020 | |
| 050 | 16851-96270 | KAPPE | CAP,SEALING | 8 | | | 0.005 | |
| 060 | 15321-96260 | KAPPE | CAP,SEALING | 1 | | <=BTZ999 | 0.014 | |
| 060 | 15321-96260 | KAPPE | CAP,SEALING | 2 | | >=BU0001 | 0.014 | |
| 070 | 15521-96020 | STOPFEN | PLUG | 1 | | | 0.003 | |
| 080 | 1G772-03450 | BOLZEN | BOLT | 10 | | | 0.175 | |
| 090 | 1G777-03310 | ZYLINDERKO PFDICHTUNG | GASKET,CYLI NDER HEAD | 1 | | | 0.180 | STD/ 2 KERBEN |
| 090 | 1G777-03600 | ZYLINDERKO PFDICHTUNG | GASKET,CYLI NDER HEAD | 1 | | | 0.210 | VERWENDUN G / 1 KERBE |
| 090 | 1G777-03610 | ZYLINDERKO PFDICHTUNG | GASKET,CYLI NDER HEAD | 1 | | | 0.210 | VERWENDUN G / KEINE KERBE |

Update Date : 11-07-2019 Print Date : 12-04-2022

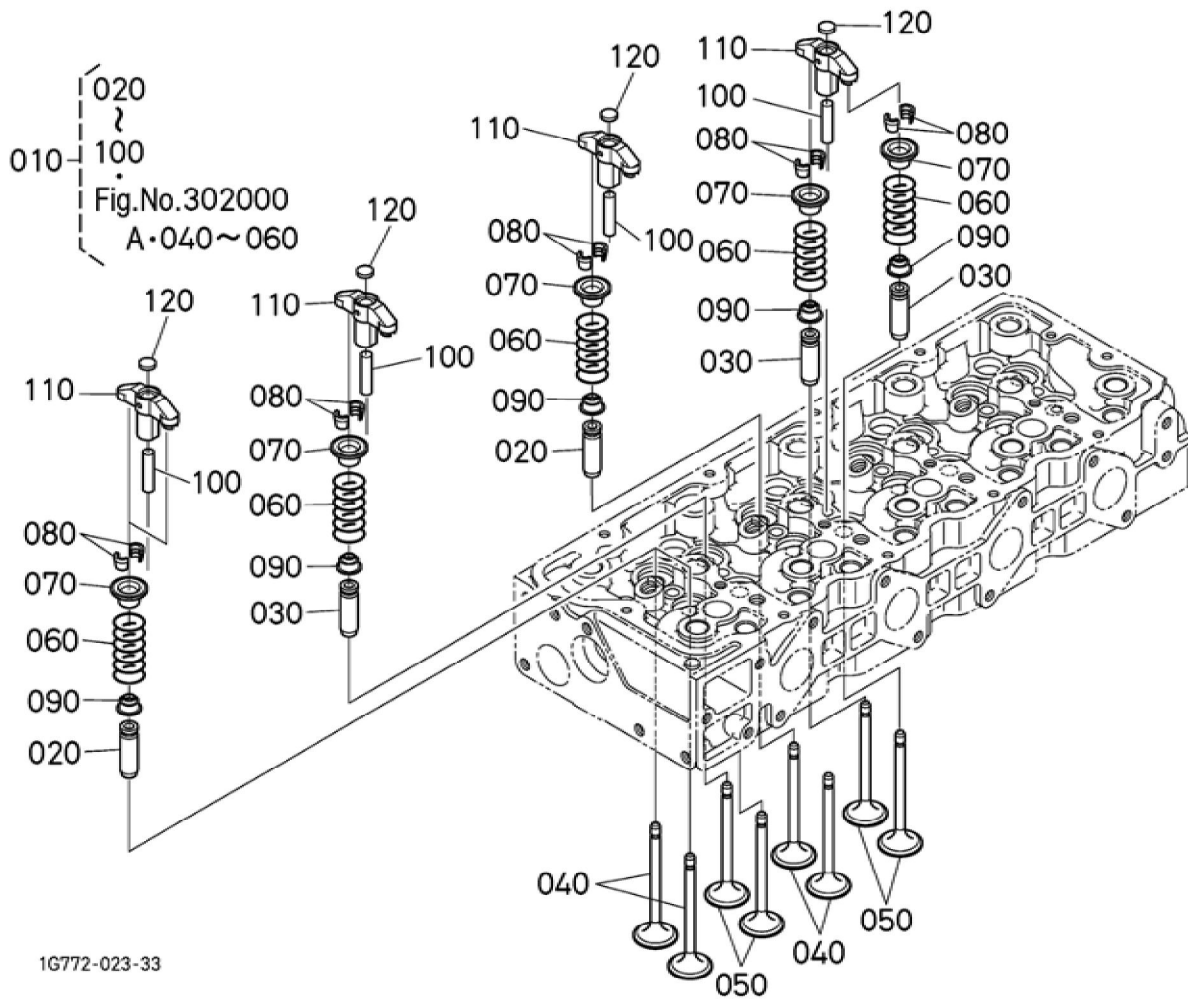

Update Date : 11-07-2019 Print Date : 12-04-2022

| No. | Part Number | Part Name (POL) | Part Name (ENG) | QTY | IC | Serial No./PIN | Kg | Remarks |
|-----|-------------|-----------------------|-----------------------|-----|----|----------------|--------|------------------------------------------------|
| 010 | 1G777-03020 | GRP.ZYLINDERKOPF | ASSY CYLINDER HEAD | 1 | | <=AXZ999 | 25.900 | ORDER BY REF.No.010 and 110 NEW PARTS. |
| 010 | 1G777-03022 | GRP.ZYLINDERKOPF | ASSY CYLINDER HEAD | 1 | NI | >=AY0001 | 23.500 | |
| 020 | 16261-13540 | EINLASSVENTILFUEHRUNG | GUIDE,INLET VALVE | 8 | | | 0.020 | |
| 030 | 16261-13560 | AUSLASSVENTILFUEHRUNG | GUIDE,EXHAUST VALVE | 8 | | | 0.019 | |
| 040 | 1G772-13110 | EINLASSVENTIL | VALVE,INLET | 8 | | <=AXZ999 | 0.055 | BESTELLEN SIE BITTE POS.040 UND 110 NEUE TEILE |
| 040 | 1G772-13112 | EINLASSVENTIL | VALVE,INLET | 8 | NI | >=AY0001 | 0.055 | |
| 050 | 1G772-13120 | AUSLASSVENTIL | VALVE,EXHAUST | 8 | | <=AXZ999 | 0.050 | BESTELLEN SIE BITTE POS.050 UND 110 NEUE TEILE |
| 050 | 1G772-13122 | AUSLASSVENTIL | VALVE,EXHAUST | 8 | NI | >=AY0001 | 0.050 | |
| 060 | 1C010-13240 | VENTILFEDER | SPRING,VALVE | 16 | | | 0.020 | |
| 070 | 16261-13330 | HALTER,VENTILFEDER | RETAINER,VALVE SP. | 16 | | | 0.015 | |
| 080 | 15261-13980 | KLEMMSCHEIBE | COLLET (VALVE SPRING) | 16 | | | 0.002 | SET |
| 090 | 1C010-13150 | VENTILDICHTUNG | SEAL,VALVE STEM | 16 | | | 0.002 | |
| 100 | 1C010-13482 | VENTILFUEHRUNG | SHAFT,VALVE BURIGE | 8 | | | 0.020 | |
| 110 | 1C020-13463 | HUBARM,VENTIL | ARM,VALVE BURI. | 8 | | <=AXZ999 | 0.062 | |
| 110 | 1G772-13460 | HUBARM,VENTIL | ARM,VALVE BURI. | 8 | NI | >=AY0001 | 0.050 | |
| 120 | 1C010-13490 | PUFFER | PAD | 8 | | <=9U0595 | 0.003 | |
| 120 | 1J700-13492 | PUFFER | PAD | 8 | >> | >=9W0001 | 0.003 | |



Download the full PDF manual instantly.

Our customer service e-mail:

aservicemanualpdf@yahoo.com