

BKIDK5232 >> L245F >> ENGINE / ENGINE >> 001000 CRANKCASE / CRANKCASE

Update Date : 09-03-2018 Print Date : 02-03-2022

No.	Part Number	Part Name (POL)	Part Name (ENG)	QTY	IC	Serial No./PIN	Kg	Remarks
001	15341-01010	GRP.KURBEL GEHAEUSE	ASSY CRANKCASE	1		<=14147	0.000	
001	15341-01013	GRP.KURBEL GEHAEUSE	ASSY CRANKCASE	1		=>14148	55.000	
003	34150-27580	STOPFEN	PLUG	5		<=14147	0.001	
003	34150-27580	STOPFEN	PLUG	1		=>14148	0.001	
004	06311-75015	STOPFEN	PLUG EXPANSION	3			0.002	
005	15221-03380	STOPFEN	CAP SEALING	5			0.017	
006	15221-03390	STOPFEN	CAP SEALING	2			0.030	
007	06311-75045	STOPFEN	PLUG EXPANSION	1			0.026	
008	15221-33630	STOEPSELST IFT	PLUG PIN	5		<=14147	0.001	
008	15221-33630	STOEPSELST IFT	PLUG PIN	4		=>14148	0.001	
008	15521-96020	STOPFEN	PLUG PIN	5			0.003	
009	15221-33640	STOEPSELST IFT	PLUG PIN	1			0.003	
009	15521-96030	STOPFEN	PLUG	2			0.007	
010	05012-00408	ZYLINDERSTI FT	PIN STRAIGHT	2			0.001	
011	05012-00609	ZYLINDERSTI FT	PIN STRAIGHT	2			0.003	
012	05012-00612	ZYLINDERSTI FT	PIN STRAIGHT	2			0.003	
013	05012-01018	ZYLINDERSTI FT	PIN STRAIGHT	3			0.012	
014	15221-33650	ROHRSTIFT	PIN PIPE	1			0.004	
015	15221-72840	WASSERROH R	PIPE WATER	1			0.078	
016	15221-02310	ZYLINDERAU FBUECHSE	LINER CYLINDER	3			0.580	
017	15221-33610	STOPFEN	PLUG	1			0.009	
018	15021-33660	DICHTUNGSP LATTE	GASKET	1			0.001	
019	15221-33750	STOPFEN	PLUG	1		<=14147	0.032	

BKIDK5232 >> L245F >> ENGINE / ENGINE >> 001000 CRANKCASE / CRANKCASE

Update Date : 09-03-2018 Print Date : 02-03-2022

No.	Part Number	Part Name (POL)	Part Name (ENG)	QTY	IC	Serial No./PIN	Kg	Remarks
019	15521-33630	STOEPSELST IFT	PLUG	1		=>14148	0.003	
019	15521-33620	STOPFEN	PLUG	1			0.004	
019	15521-96010	STOPFEN	PLUG	1			0.010	
020	15109-33660	DICHTUNGSP LATTE	GASKET	1		<=14147	0.001	
021	15341-01610	OL-FANGER	OIL PAN	1			1.620	
021	15301-01610	OL-FANGER	OIL PAN	1			11.400	
022	15341-01620	DICHTUNG,O EL FAENGER	GASKET OIL PAN	1		<=6028	0.000	
022	15301-01620	DICHTUNG	GASKET OIL PAN	1			0.000	
023	01173-51025	BOLZEN	BOLT	20		=>5029	0.021	
023	01173-51035	BOLZEN	BOLT	16			0.025	
023	01133-51035	BOLZEN	BOLT	16		=>1001	0.030	
024	04512-50100	FEDERRING	WASHER SPRING	20			0.003	
024	04512-50100	FEDERRING	WASHER SPRING	4		=>1001	0.003	
025	15221-33750	STOPFEN	PLUG	1			0.032	
025	15221-33750	STOPFEN	PLUG	2			0.032	
026	15109-33660	DICHTUNGSP LATTE	GASKET	1		<=6028	0.001	
026	15109-33660	DICHTUNGSP LATTE	GASKET	2			0.001	
027	15291-32110	OELFILTER	FILTER OIL	1		=>6029	0.170	
027	15301-32110	OELFILTER	FILTER OIL	1			0.230	
028	01053-50816	BOLZEN	BOLT	1			0.011	
028	01123-50816	BOLZEN	BOLT	1		=>1001	0.011	
029	04811-00140	O RING	O RING	1			0.001	
030	15213-32020	ASSY FILTER OIL 2	ASSY FILTER OIL 2	1			0.890	
031	15213-32320	DICHTUNGSP LATTE	GASKET	1			0.000	
032	01053-50842	BOLZEN	BOLT	4			0.019	
032	01153-50842	BOLZEN	BOLT	4		=>1001	0.018	
033	04512-50080	FEDERRING	WASHER SPRING	5			0.002	

BKIDK5232 >> L245F >> ENGINE / ENGINE >> 001000 CRANKCASE / CRANKCASE

Update Date : 09-03-2018 Print Date : 02-03-2022

No.	Part Number	Part Name (POL)	Part Name (ENG)	QTY	IC	Serial No./PIN	Kg	Remarks
033	04512-50080	FEDERRING	WASHER SPRING	4		=>1001	0.002	
034	04012-50080	SCHEIBE	WASHER PLAIN	4		<=14147	0.001	
035	15342-36410	OELMESSST AB	GAUGE OIL	1			0.025	
036	04811-00050	O RING	O RING	2			0.001	
037	15221-33700	O RING	O RING	1			0.001	
038	14412-73110	ABLASSHAHN	ASSY COCK DRAIN	1			0.090	
039	15221-39010	OELDRUCKSCHALTER	SWITCH OIL	1			0.000	
040	15201-94010	SCHEIBE	WASHER PLAIN	20		<=6028	0.007	
040	15411-91010	BOLZEN	BOLT	4		=>6029	0.000	
041	32210-27580	STOPFEN	PLUG	8		=>14148	0.001	
042	15291-73160	ABLASSPROPFEN	JOINT DRAIN COCK	1		=>14148	0.040	
043	15521-33610	STOPFEN	PLUG	1			0.002	

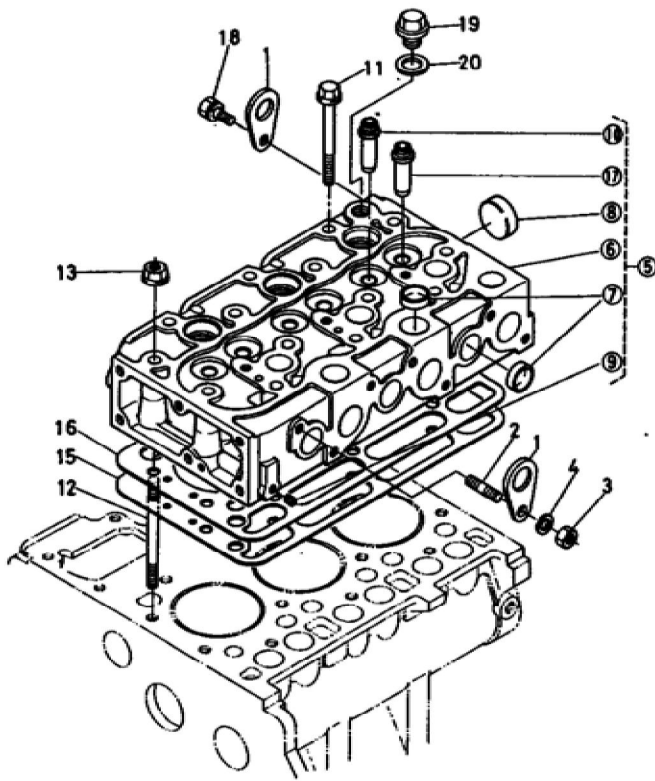

REF. No. ② 01513-50816
③ 02056-50080
④ 04512-50080

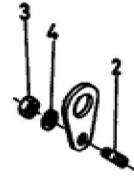

REF. No. ① 15221-0345-0
② 15221-0351-0

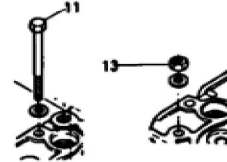

REF. No. ③ 15221-0354-0

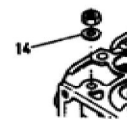

Discontinua.

BKIDK5232 >> L245F >> ENGINE / ENGINE >> 002000 CYLINDER HEAD / CYLINDER HEAD

Update Date : 09-03-2018 Print Date : 02-03-2022

No.	Part Number	Part Name (POL)	Part Name (ENG)	QTY	IC	Serial No./PIN	Kg	Remarks
001	15221-01750	MOTORHAKE N	HOOK ENGINE	2			0.040	
002	01513-50816	STEBBOLZEN	STUD	2			0.009	
002	15521-91490	STEBBOLZEN	STUD	1		=>1001	0.000	
003	05411-00845	STIFT	NUT	2			0.011	
003	02156-50080	MUTTER	NUT	1		=>1001	0.004	
004	04512-50080	FEDERRING	WASHER SPRING	2			0.002	
004	04512-50080	FEDERRING	WASHER SPRING	1		=>1001	0.002	
005	15321-03040	GRP. ZYLINDERKO PF	ASSY CYLINDER HEAD	1		<=2641	14.900	
005	15321-03045	GRP. ZYLINDERKO PF	ASSY CYLINDER HEAD	1		=>2642	0.000	
007	15221-03370	STOPFEN	CAP SEALING	9			0.010	
008	15221-03490	STOPFEN	CAP SEALING	1			0.020	
009	15131-01380	STOEPSELST IFT	PLUG PIN	2			0.001	
010	15221-13580	EINLASSVEN TILFUHRUNG	GUIDE VALVE	6		<=2641	0.000	
010	15221-13580	EINLASSVEN TILFUHRUNG	GUIDE VALVE	3		=>2642	0.000	
011	15221-03450	ZYLINDERKO PFBOLZEN	BOLT CYLINDER HEAD	12		<=25384	0.000	
011	19202-03450	ZYLINDERKO PFSCHRAUB E	BOLT CYLINDER HEAD	12		=>25385	0.065	
012	15221-03410	STEBBOLZEN	BOLT CYLINDER HEAD	2		<=25384	0.000	
012	19202-03410	STEBBOLZEN	BOLT CYLINDER HEAD	2		=>25385	0.065	
013	15221-03510	MUTTER ZYLINDERKO PF	NUT CYLINDER HEAD	2		<=25384	0.008	
013	19202-03510	MUTTER,ZYLI NDERKOPF	NUT CYLINDER HEAD	2		=>25385	0.012	
014	15221-03540	SCHEIBE	WASHER PLAIN	14			0.003	
015	15321-03310	ZYLINDERKO PFDICHTUNG	GASKET CYLINDER HEAD	1			0.000	

BKIDK5232 >> L245F >> ENGINE / ENGINE >> 002000 CYLINDER HEAD / CYLINDER HEAD

Update Date : 09-03-2018 Print Date : 02-03-2022

No.	Part Number	Part Name (POL)	Part Name (ENG)	QTY	IC	Serial No./PIN	Kg	Remarks
016	15321-03320	SHIM CYL.HEAD GASKET	SHIM CYL.HEAD GASKET	1			0.047	
017	15601-13560	AUSLASSVEN TILFUHRUNG	GUIDE EXHAUST VALVE	3		=>2642	0.000	
018	01123-50816	BOLZEN	BOLT	1		=>14148	0.011	
019	15000-36080	STOPFEN,ZY LINDERKOPF	PLUG	1		=>14148	0.030	
020	04717-01600	GUMMIUNTE RLAGE	WASHER SEAL	1		=>14148	0.003	

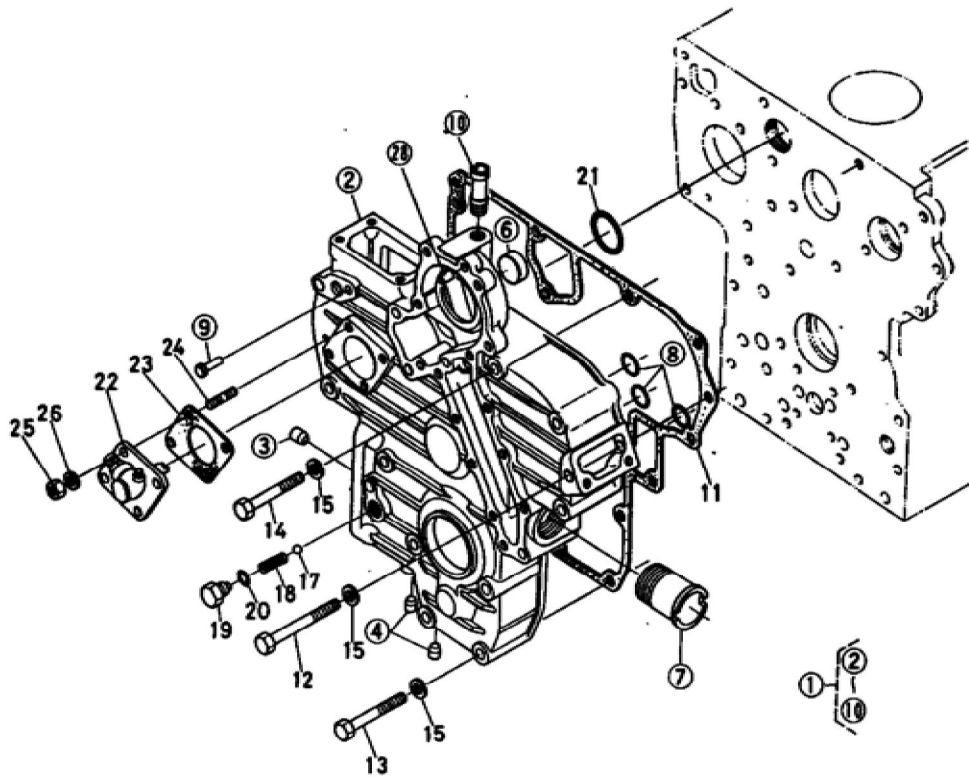

REF. No/1 15221-0402-0
Q/15221-0413-0

REF. No/3 15221-0349-0
Q/04012-50080
Q/04012-50050

Discontinance.

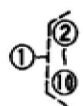



Download the full PDF manual instantly.

Our customer service e-mail:

aservicemanualpdf@yahoo.com